

INSTALLATION INSTRUCTIONS



WEB-HMI touch panels are available in 5 different sizes which offer 2 tiers of visualization and connectivity performance:

1. Direct controller access (Browse in controller)
2. System wide controller access (Browse into the system)

WEB-HMI seamlessly integrates with CIPer Model 10, CIPer Model 30, CIPer Model 50, and WEB-8000 delivering robust performance and comprehensive insight from the controller or building system.

GENERAL

The WEB-HMI series of touchscreen monitors are HTML5 IP browser compatible touchscreen monitors. They combine state-of-the-art features and top performance with an outstanding design.

INSTALLATION

1. Read these instructions carefully. Failure to follow them could damage the product or cause a hazardous condition.
 2. Check ratings given in instructions and on the product to ensure the product is suitable for the application.
 3. Installer must be a trained, experienced service technician.
 4. After installation is complete, check out product operation as provided in these instructions.
- ordering information

ORDERING INFORMATION

Table 1. HMI Touch panel models

	WEB-HMI4/C	WEB-HMI7/C	WEB-HMI10/CF	WEB-HMI15/CF	WEB-HMI21/CF
Type	4.3" HTML5 Web Panel, resistive touch	7" HTML5 Web Panel, resistive touch	10.1" HTML5 Web Panel, capacitive touch	15.6" HTML5 Web Panel, capacitive touch	21.5" HTML5 Web Panel, capacitive touch
Description	4.3" HTML5 Web Panel, TFT color, 480 × 272 pixel, resistive touch screen, 1 Ethernet port, 1 USB host port	7" HTML5 Web Panel, TFT color, 800 × 480 pixel, resistive touch screen, 1 Ethernet port, 1 USB host port	10.1" HTML5 Web Panel, TFT color, 1280 × 800 pixel, capacitive multi touch screen, 3 Ethernet port, 2 USB host port	15.6" HTML5 Web Panel, TFT color, 1366 × 768 pixel, capacitive multi touch screen, 3 Ethernet port, 2 USB host port	21.5" HTML5 Web Panel, TFT color, 1920 × 1080 pixel, capacitive multi touch screen, 3 Ethernet port, 2 USB host port

DIMENSIONS

Resistive touch panel

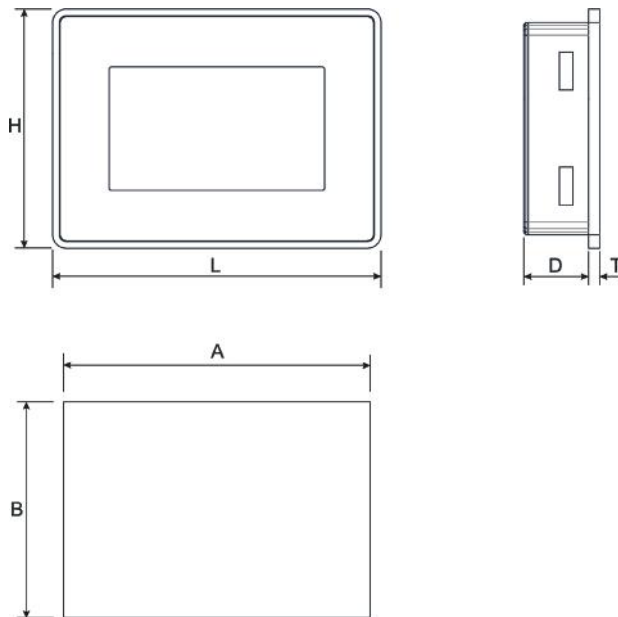

Table 2. Dimensions

	WEB-HMI4/C	WEB-HMI7/C
A	05.35" (136 mm)	06.90" (176 mm)
B	03.78" (96 mm)	05.35" (136 mm)
D	01.14" (29 mm)	01.14" (29 mm)
H	04.21" (107 mm)	05.79" (147 mm)
L	05.78" (147 mm)	07.36" (187 mm)
T	00.19" (5 mm)	00.19" (5 mm)
CSD	13.77" (350 mm)	19.68" (500 mm)
CSD2	07.87" (200 mm)	15.74" (400 mm)



NOTE:

Resistive touch panels: Check that graphic panels are mounted completely inside in enclosures satisfying minimum IP54 degree of protection for application in zone 2 and IP6x for application in zone 22.

Capacitive touch panel

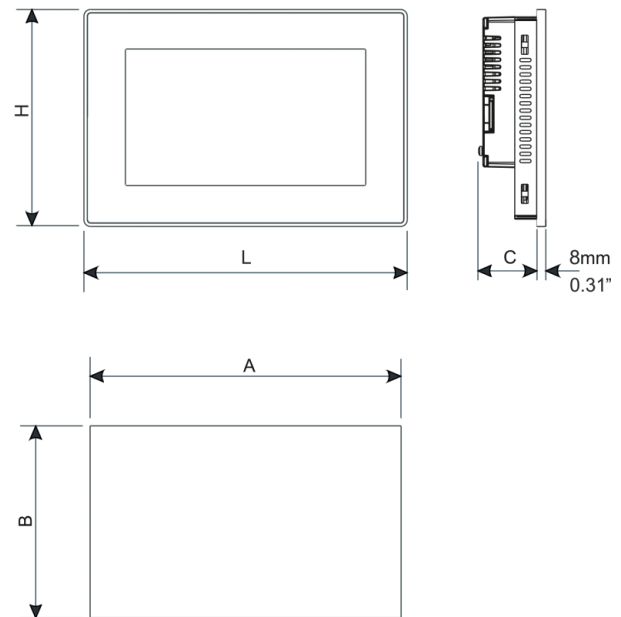

Table 3. Dimensions

	WEB-HMI10/CF	WEB-HMI15/CF	WEB-HMI21/CF
A	10.66" (271 mm)	16.18" (411 mm)	21.30" (541 mm)
B	07.32" (186 mm)	10.00" (256 mm)	13.22" (336 mm)
C	02.20" (56 mm)	02.20" (56 mm)	02.20" (56 mm)
H	07.75" (197 mm)	10.50" (267 mm)	13.66" (347 mm)
L	11.10" (282 mm)	16.60" (422 mm)	21.73" (552 mm)
CSD	45.28" (1150 mm)	70.87" (1800 mm)	86.61" (2200 mm)
CSD2	29.53" (750 mm)	51.18" (1300 mm)	51.18" (1300 mm)

CSD = Minimum Compass Safe Distance of standard compass.

CSD2 = Minimum Compass Safe Distance of steering compass, standby steering compass, emergency compass.



NOTE:

Capacitive touch panels: Check that graphic panels are mounted in enclosures satisfying minimum IP54 degree of protection for category 3G and IP6x for category 3D and the requirements relating to the 3G or 3D categories in Zones 2/22 (Category 3: normal level of protection - G: Gas - D: Dust).

INSTALLATION PROCEDURE

Place the fixing brackets contained in the fixing kit as shown below

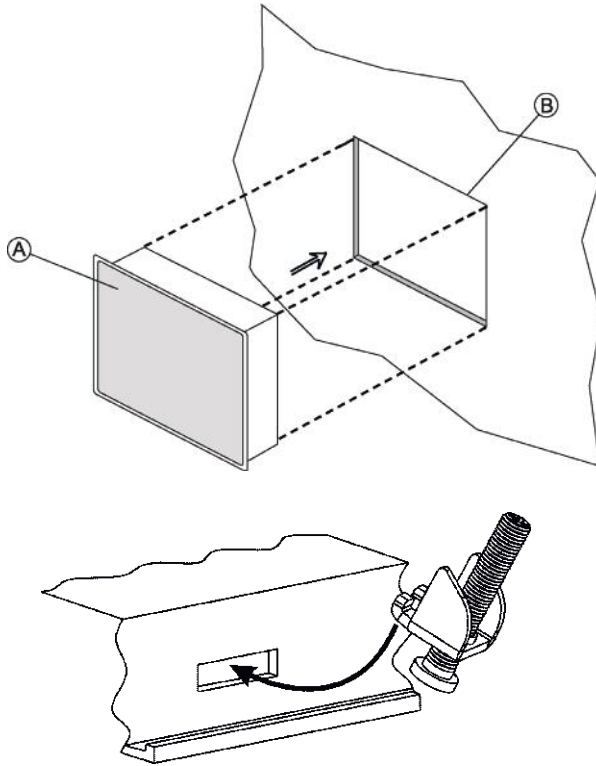

- A WEB-HMI
B Installation cut-out (*)

Table 4. Fixing Bracket

Model	Number of pieces
WEB-HMI4/C	4 pieces
WEB-HMI7/C	4 pieces
WEB-HMI10/CF	9 pieces
WEB-HMI15/CF	12 pieces
WEB-HMI21/CF	14 pieces

CAUTION

Tightening torque for resistive touch panel:
75Ncm or screw each fixing screw until the
bezel corner gets in contact with the panel.

Tightening torque for capacitive touch panel:
130Ncm or screw each fixing screw until the
bezel corner gets in contact with the panel.

WARNING

Power, input and output (I/O) wiring must be
in accordance with class i, division 2 wiring
methods, article 501.10 (b) of the national
electrical code, NFPA 70 for installation in the
U.S., or as specified in section 18-1J2 of
Canadian electrical code for installations
within Canada and in accordance with the
authority having jurisdictions.

Substitution of any component may impair
suitability for class i, division 2

When in hazardous locations, turn off power
before replacing or wiring modules

Do not disconnect equipment while the circuit
is live or unless the area is known to be free of
ignitable concentrations.

Do not change battery unless the area is
known to be free of ignitable concentrations

This equipment, except for the front panel
display, is an open-type device and is required
to be installed in an enclosure suitable for the
environment such that the internal part of the
equipment is only accessible with the use of a
tool.

Suitable for use in Class I, Division 2, Groups
A, B, C And D Hazardous Locations, Or
Nonhazardous Locations Only.

CONNECTIONS

Resistive touch panel

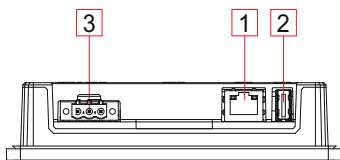

Figure 1. Resistive touch panel rear view

Table 5. Resistive touch panel ports

Callout	Specification
1	Ethernet port
2	USB port (version 2.0, 5V 500mA max - for maintenance only)
3	Power supply (10-32Vdc)

Capacitive touch panel

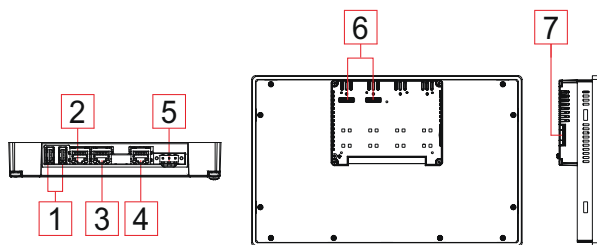

Figure 2. Capacitive touch panel rear view

Table 6. Capacitive touch panel ports

Callout	Description
1	USB port (version 2.0, 500mA max - for maintenance only)
2	Ethernet port 2 (10/100 Mb)
3	Ethernet port 1 (10/100 Mb)
4	Ethernet port 0 (10/100/1000 Mb)
5	Power supply (10-32Vdc)
6	2 Expansion slots for plug-in modules (not supported)
7	SD Card slot (for maintenance only)

! WARNING

(USB Connectors) Not for use in hazardous locations.

(Ethernet, USB connectors, memory card slot)
Do not connect or disconnect unless the power has been disconnected or the area is known to be free of ignitable concentrations.

! CAUTION

All ports are SELV (Safety Extra - Low Voltage) according European Standards and Class 2 according UL Standards

Don't open the panel rear cover when the power supply is applied.

Usage in explosion-hazardous areas zone 2 and zone 22

CAUTION

Confirm that the location is free from explosively hazardous gases or dust before connecting or disconnecting equipment, replacing or wiring modules. Confirm that the power supply has been turned OFF before disconnecting, replacing or wiring modules.

Before turning ON, clean the front panel of the graphic panel with a damp cloth to avoid any electrostatic discharge.

The graphic panel must not be exposed to direct sunlight.

The vents in the panel casing must not be obstructed.

Do not allow layers of dust to form on the graphic panel: it should be cleaned regularly making clean with a damp cloth.

Ensure that the labeling specifications are compatible with the conditions permitted for the hazardous area at the site where it is being used (Zones 2/22 Group II: Surface industries - Category 3: Normal level of protection - G: Gas - D: Dust - IP: degree of protection (protection against solids and liquids) - T: maximum surface temperature).

DISPOSAL

Disposal of Batteries

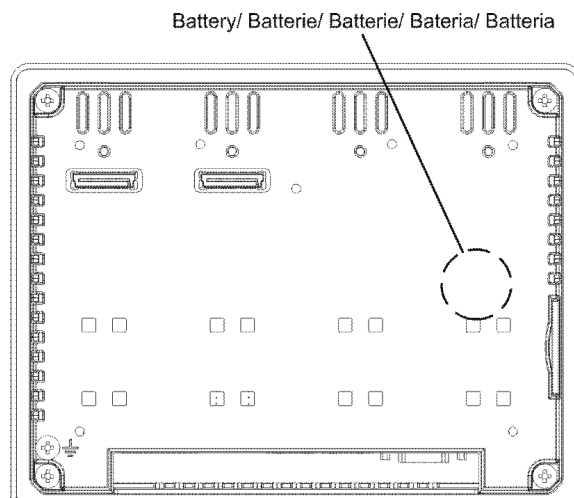

Capacitive touch panels are equipped with rechargeable Lithium battery, these are not user-replaceable. The following information is maintained by the battery:

- Hardware real-time clock (date and time)

Charge: At first installation, it must be charged for 48 hours. When the battery is fully charged, it ensures a period of 3 months of data back-up at 77°F (25°C).



CAUTION

Dispose the batteries according to local regulations.



WEEE DIRECTIVE

This device cannot be disposed of as a domestic waste but according to WEEE European Directive 2012/19/EU

STANDARDS AND APPROVALS

Resistive touch panels

The products have been designed for use in an industrial environment in compliance with the 2014/30/EU EMC Directive.

The products have been designed in compliance with:

EN 61000-6-4 EN 61000-6-3	EN 55011 Class A EN 55022 Class B
EN 61000-6-2 EN 61000-6-1	EN 61000-4-2 EN 61000-4-3 EN 61000-4-4 EN 61000-4-5 EN 61000-4-6 EN 61000-4-8
EN 60079-0	
EN 60079-7	
EN 60079-11	

Special instruction for use

- The equipment shall only be used in an area of not more than pollution degree 2, as defined in IEC/EN 60664-1.
- The equipment shall be installed in an enclosure that provides a degree of protection not less than IP 54 in accordance with IEC/EN 60079-7.
- Transient protection shall be provided that is set at a level not exceeding 140% of the peak rated voltage value at the supply terminals to the equipment.

Capacitive touch panels

The products have been designed for use in an industrial environment in compliance with the 2004/108/EC EMC Directive.

The products have been designed in compliance with:

EN 61000-6-4	CISPR 22 Class A CISPR 16-2-3
EN 61000-6-2	EN 61000-4-2 EN 61000-4-3 EN 61000-4-4 EN 61000-4-5 EN 61000-4-6 EN 61000-4-8 EN 61000-4-11 EN 61000-4-29 EN60945

The installation of these devices into the residential, commercial and light-industrial environments is allowed only in the case that special measures are taken in order to ensure conformity to EN 61000-6-3.

The products are in compliance with the Restrictions on Certain Hazardous Substances (RoHS) Directive 2011/65/EU.

In compliance with the above regulations the products are CE marked.

In compliance with the above regulations the products are CE marked.

This device complies with part 15 of the FCC Rules. Operation is subject to the following two conditions:

1. This device may not cause harmful interference,
2. This device must accept any interference received, including interference that may cause undesired operation.

Declaration of REACH conformity

Article 33 Communication

REGULATION (EC) No 1907/2006 OF THE EUROPEAN PARLIAMENT AND OF THE COUNCIL of 18 December 2006

Honeywell takes compliance with REACH very seriously.

According to Article 33 "Duty to communicate information on substances in articles":

1. Any supplier of an article containing a substance meeting the criteria in Article 57 and identified in accordance with Article 59(1) in a concentration above 0.1 % weight by weight (w/w) shall provide the recipient of the article with sufficient information, available to the supplier, to allow safe use of the article including, as a minimum, the name of that substance.
2. On request by a consumer any supplier of an article containing a substance meeting the criteria in Article 57 and identified in accordance with Article 59(1) in a concentration above 0.1 % weight by weight (w/w) shall provide the consumer with sufficient information, available to the supplier, to allow safe use of the article including, as a minimum, the name of that substance.

Our duty is to inform you that the substance(s) listed below may be contained in these products above the threshold level of 0.1% by weight of the listed article

Table 7. Capacitive touch panels

SVHC Substance	CAS Number
Lead	7439-92-1
Diboron trioxide	1303-86-2
Lead titanium zirconium oxide	12626-81-2

Table 7. (Continued) Capacitive touch panels

SVHC Substance	CAS Number
4,4'-isopropylidenediphenol [Bisphenol A; BPA]	80-05-7
Lead monoxide (lead oxide)	1317-36-8
2-(2H-benzotriazol-2-yl)-4,6-ditertpentylphenol (UV-328)	25973-55-1
2-methyl-1-(4-methylthiophenyl)-2-morpholinopropan-1-one	71868-10-5
Decamethylcyclopentasiloxane (D5)	541-02-6
Boric acid	10043-35-3 / 11113-50-1
Octamethylcyclotetrasiloxane (D4)	556-67-2
Dodecamethylcyclotetrasiloxane (D6)	540-97-6

Table 8. Resistive touch panels

SVHC Substance	CAS Number
1,2-dimethoxyethane; ethylene glycol dimethyl ether (EGDME)	110-71-4
Lead	7439-92-1
4,4'-isopropylidenediphenol [Bisphenol A; BPA]	80-05-7
Diboron trioxide	1303-86-2
Lead titanium zirconium oxide	12626-81-2

Any further information will be available on request.

The declaration does not concern the supply of components by the customer, intended to be part of the finished product to be supplied to the customer.

We confirm that our products do not use any other REACH restricted materials during the manufacturing, storage or handling process.

www.nicsanat.com
021-87700210



The material in this document is for information purposes only. The content and the product described are subject to change without notice. Honeywell makes no representations or warranties with respect to this document. In no event shall Honeywell be liable for technical or editorial omissions or mistakes in this document, nor shall it be liable for any damages, direct or incidental, arising out of or related to the use of this document. No part of this document may be reproduced in any form or by any means without prior written permission from Honeywell.

Honeywell Building Technologies

Honeywell
715, Peachtree street NE
Atlanta, GA 30308
buildings.honeywell.com

® U.S. Registered Trademark
©2020 Honeywell International Inc.
31-00390-02 | Rev. 07-21

Honeywell